

# CUSTOMER INSTALLATION INSTRUCTIONS

Reliability by Design.

IN0158 R1 U-Pillar Outgoing Shear Bolt KP435 Assembly  
Instructions

14 Nov 2024

## 1 Purpose

The purpose of this document is to provide guidelines for U-Pillar outgoing shear bolt KP435 assembly

Compliance must be maintained to the required regulations, standards, and environmental and safety requirements, including safe work practices as specified in local and national work instructions and codes.

In addition to these instructions, installation must comply with any other relevant general or site specific: regulations, standards, and environmental and safety requirements, including safe work practices, as specified in local and/or national work instructions or codes.

## 2 Scope

This work instruction assumes all U-Pillar access works will be undertaken by appropriately trained and qualified persons.

## 3 References

- EEA Guide to Live LV Electrical Work
- EEA Guide for Livening of Service Connections to Premises

## 4 Important Safety Information

- Wear appropriate personal protective equipment.
- Ensure all electrical components are isolated before making connections.
- Complete a risk assessment prior to commencing site work.
- Unauthorised modification of the safety critical components such as the lid, or structural supporting components, or sealing components is not permitted. If in doubt, contact Hiko for advice.



**An airtight seal of cable shear bolt is a very important U-Pillar safety function to prevent flooding of the switchgear under the bell.**

## 5 U-Pillar Outgoing Cable - 16mm<sup>2</sup> KP435 Phase

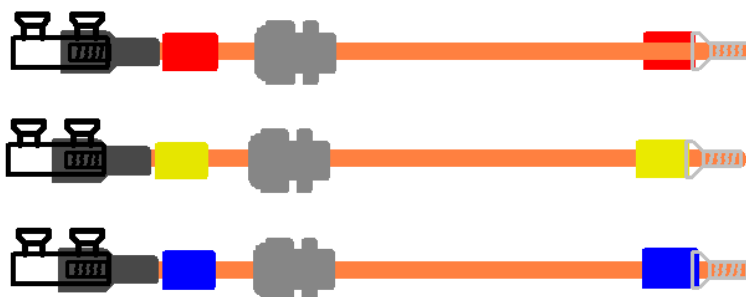

- **Uninsulated Ferrules**

Complete Insert the cable into the Uninsulated Ferrule 16mm<sup>2</sup> (WETF1618). Ensure that all copper strands are in the ferrule. It is not required to crimp the uninsulated ferrules.

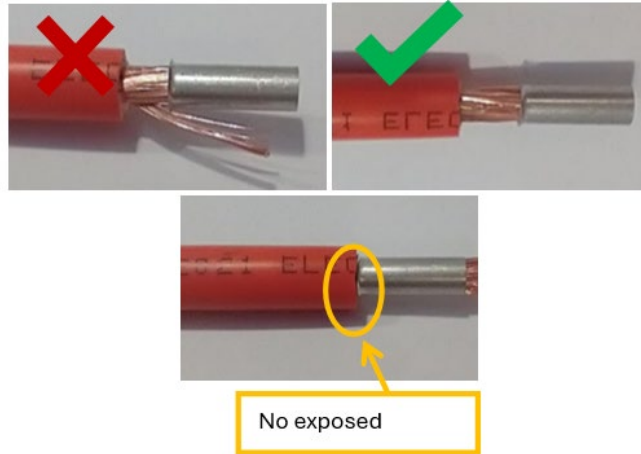

- **Shear bolt**

Insert the uncrimped uninsulated ferrule into a shear bolt (Link Shear Bolt Connector 4 to 35mm<sup>2</sup> (332 799 702) - KP435). Tighten the screw until it shears off the head.

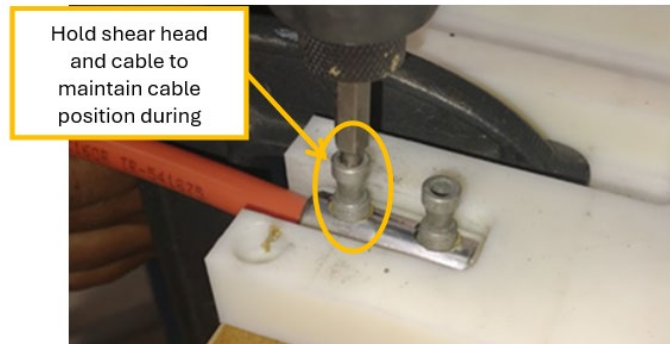

- **Mastic tape**

Wrap the cable joint using hot melt mastic sealing tape (WESP0009).

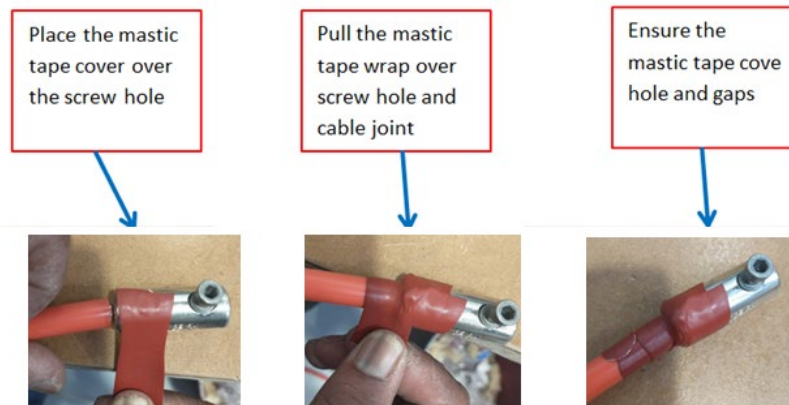

- **Heat shrinking the shear bolt**

Using a heat gun, heat shrink an 80mm length of the Heat Shrink Tubing Medium Wall Adhesive Lined 22-6mm Black (HTHSTMA196BK) on the shear bolt, as shown below.



**Note: Ensure the heat shrink covers the mastic tape**

- **Coloured Heat shrink at the shear bolt end**

Using a heat gun, heat shrink 40mm lengths of the Heat Shrink 2:1 Polyolefin 13mm RED (HTHS1365RDR), Heat Shrink 2:1 Polyolefin 13mm WHITE (HTHS1365WHR) or Heat Shrink 2:1 Polyolefin 13mm BLUE (N° HTHS1365BLR) according to the Kanban bin colour.

